

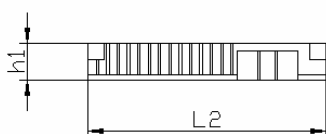

data sheet

system:	Lithium-Ion-Battery
nominal voltage:	3,7V
end charge voltage:	4,2V
max. charge current:	950mA
charge conditions	
standard charge:	475mA for 3,5h min.
fast charge:	950mA for 2,5h min.
charging method:	CC-CV (constant current and constant voltage)
capacity	
nominal:	after standard charge 950mAh at 0,2C discharge to 2,75V
minimal:	860mAh at 0,2C discharge 750mAh at 1C discharge
max. discharge current:	950mA
life time expectancy:	> 300 cycles
ambient temperature range	
charge:	0...45°C
discharge:	-20...60°C
long term storage:	-20...35°C (less than 1 year)
weight:	32g
dimensions:	L1: 65,1mm L2: 39,5mm h1: 6,7mm

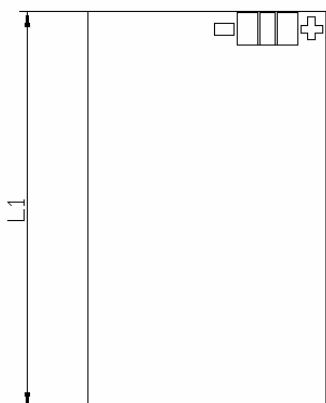

	specifications for model/type:	A – Eso3 (Sony Ericsson P800 P900)
	Ansmann drawing number / part number:	5060033
	drawn by / date:	Gramlich / 04.07.2005